

For self-tapping screws
with thread 2.9*1.06

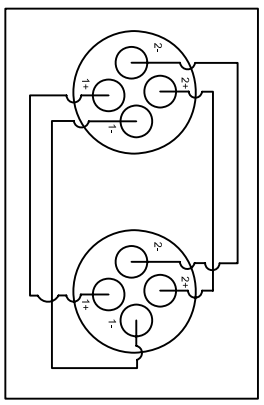
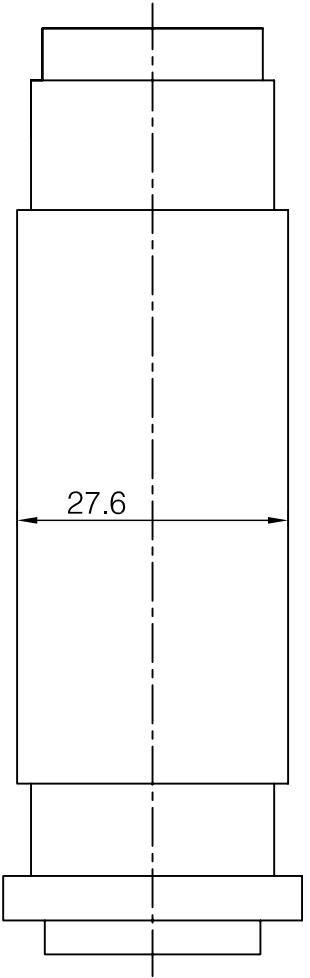

PIN DEFINE

DIMENSIONS IN MILLIMETERS
3rd ANGLE PROJECTION
SCALE: N.T.S

DRAWN PYQ		MATERIAL: PA6/Brass - Ni Plated	
CHECKED PCS		FINISH: As Moulded	
1	1st DRAWN	14/04/16	
ISSUE	AMEND	DATE	

TOLERANCES
NO DECIMAL PLACE ± 0.5
1 DECIMAL PLACE ± 0.2
2 DECIMAL PLACES ± 0.1
DIAMETER HOLES ± 0.1
ANGLES ± 1/2 DEGREE
(UNLESS OTHERWISE STATED)



TITLE: Speaker Connector 4P to Speaker
Connector 4P

DRWG NO.: SC-2011