

ISOMETRIC VIEW

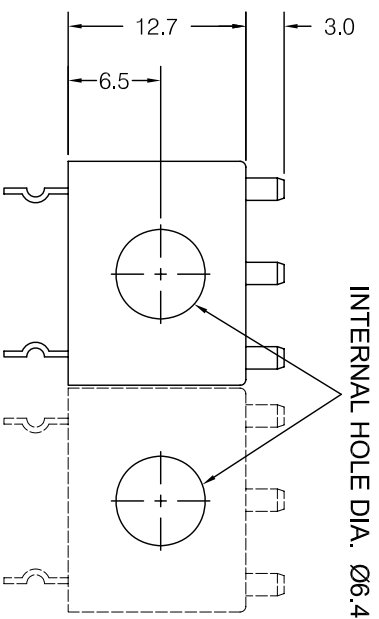
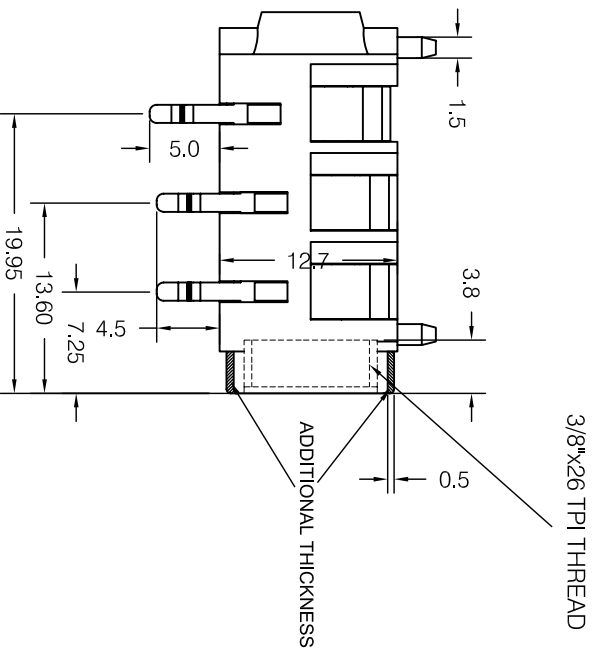

MATERIAL PROPERTIES

Parts	Description	Material	Remark
	Jack Body	Polyamide	Black
	Metal Contact	Phosphorus Bronze	Tin Plated
	FIBRE WASHER (2 Nos.)	Vulcanized Fibre	Black
	Metal Nut (3/8" x 20TPI)	Brass	Chrome Plated
	Bezel	PP	Black

DIMENSIONS IN MILLIMETERS

3rd ANGLE PROJECTION
SCALE: N.T.S.

SUPPLY METAL NUTS & WASHERS AS LOOSE PARTS

ISSUE	AMEND	DATE	CHECKED	FINISH:
1	1st DRAWN	15/03/17	PCS	AS MOULDED

DRAWN PYQ MATERIAL: SEE TABLE

TOLERANCES
NO DECIMAL PLACE ± 0.5
1 DECIMAL PLACE ± 0.2
2 DECIMAL PLACES ± 0.1
DIAMETER HOLES ± 0.1
ANGLES ± 1/2 DEGREE
(UNLESS OTHERWISE STATED)

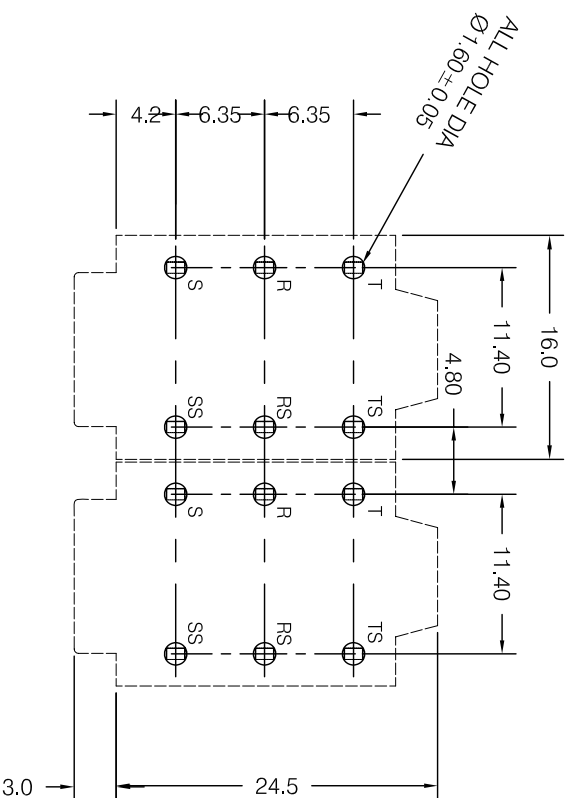

PCB LAYOUT



TITLE: 6.35mm PHONE JACK, INT THREAD/
PCC/KINK/BBB

DRWG NO: JK-1401 (Modified)

