

MATERIAL PROPERTIES

Parts	Description	Material	Remark
	Jack Body	Polyamide	Black
	Thick Spacer 6.4mm Thick	Polyamide	Black
	RFI Screen	Steel Alloy	Tin Plated
	Metal Contacts	Phosphorus Bronze	Tin Plated
	Plastic Nut 7/16 UNF 20 TP1	Polyamide	Black

SUPPLY PLASTIC NUTS AS LOOSE PARTS

DIMENSIONS IN MILLIMETERS
3rd ANGLE PROJECTION
SCALE: N.T.S

DRAWN	PYQ	MATERIAL:	SEE TABLE
CHECKED	PCS	FINISH:	AS MOULDED
ISSUE	1	1st DRAWN	08/06/14
AMEND		DATE	

TOLERANCES	
NO DECIMAL PLACE ± 1.0	1 DECIMAL PLACE ± 0.5
2 DECIMAL PLACES ± 0.1	DIAMETER HOLES ± 0.1
ANGLES ± 1/2 DEGREE	(UNLESS OTHERWISE STATED)

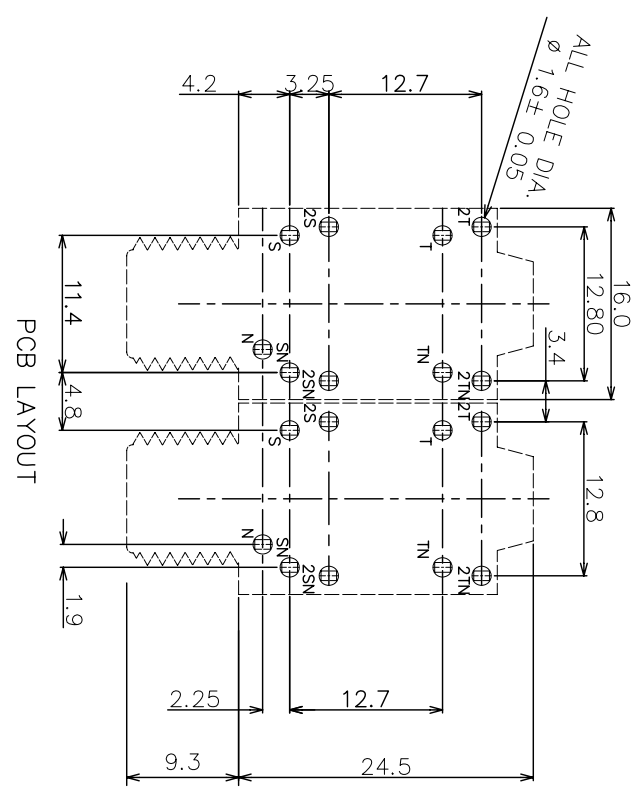
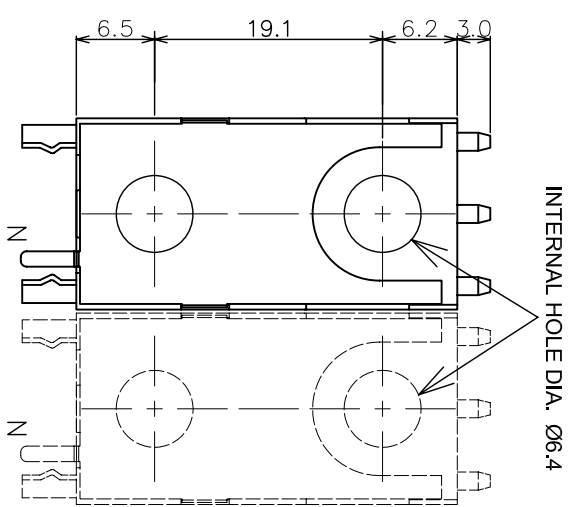

TITLE: 6.35 SLIM DOUBLE DECK JACK
DRWG NO: JK-1133

