

TYPE	TERMINAL QUANTITY	CIRCUITRY TRAIT
SPDT	6P	DN-DN

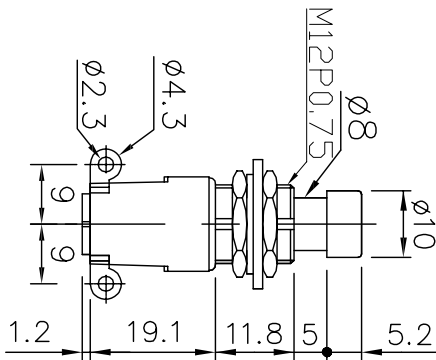
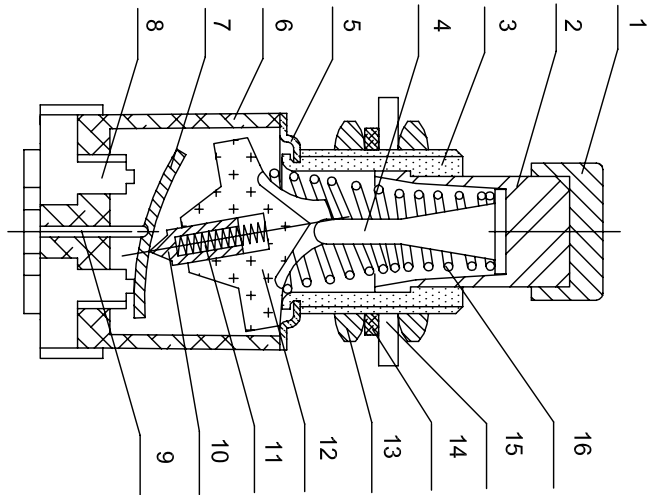

SPECIFICATION

1. Contact R. : 20mΩ Max.
2. Insulation R. : DC 500V 100MΩ Min.
3. Dielectric Strength : AC 1000V 1 minute.
4. Electrical Life : 20,000 make and break cycles at full load.

ITEM	PARTS NAME	MATERIAL	QUANTITY	REMARK
1	BRASS CAP	BRASS	1	NICKEL PLATED
2	BRASS COLUMN	BRASS	1	NICKEL PLATED
3	COLUMN JACKET	BRASS	1	NICKEL PLATED
4	SUPPORT	POM	1	-
5	CLAMP	STAINLESS STEEL	1	-
6	BASE	NYLON66	1	-
7	SPRING	BRASS	1	NICKEL PLATED
8	METAL BASE	BRASS	2	NICKEL PLATED
9	CONDUCTOR	BRASS	1	NICKEL PLATED
10	BREAKER	PF	1	-
11	SPRING	STEEL COIL	1	-
12	SWING	POM	1	-
13	NUT	BRASS	2	-
14	NUT	-	1	-
15	WASHER	POM	1	-
16	SPRING	STEEL COIL	1	-

DIMENSIONS IN MILLIMETERS
3rd ANGLE PROJECTION
SCALE: N.T.S

DRAWN XHZ MATERIAL: AS SPECIFIED

TOLERANCES
NO DECIMAL PLACE ± 0.2
1 DECIMAL PLACE ±
2 DECIMAL PLACES ±
DIAMETER HOLES ±
ANGLES ± 1/2 DEGREE
(UNLESS OTHERWISE STATED)

ISSUE	AMEND	DATE	CHECKED PCS	FINISH: AS MOULDED
1	1st DRAWN	30/09/08		

DRAWN	MATERIAL: AS SPECIFIED
XHZ	
CHECKED	FINISH: AS MOULDED
PCS	

TOLERANCES
NO DECIMAL PLACE ± 0.2
1 DECIMAL PLACE ±
2 DECIMAL PLACES ±
DIAMETER HOLES ±
ANGLES ± 1/2 DEGREE
(UNLESS OTHERWISE STATED)



TITLE: Pushbutton Switch 4066 DPDT On/Off

Solder Tag

DRWG NO: FC71055

